



SHELTER STRUCTURES AMERICA

PRODUCT SPECIFICATIONS

SHELTER L-SERIES

TENT SPECIFICATIONS

Model	L60
Span Width	60m
Eave Height	4.15m
Ridge Height	13.94m
Bay Distance	5m
Roof Pitch	18°
Longest Component	10.80m
Maximum Length	Unlimited in 5-meter increments
Max. Windload	115mph

FRAMEWORK

Main Profiles	120*420*6/7mm (4 channel)
Material	Hard Pressed Extruded Structural Aluminum 6061/T6

COVER

Material	PVC Coated Polyester Fabric
Features	650 or 850 g/sqm, Premium Grade, High Gloss White or Translucent, Waterproof, UV Resistant
Flame Retardant	DIN 4102 B1, M2; USA NFPA701

CONNECTING COMPONENTS

Hot Dipped, Structural Grade Corrosive Resistant Galvanized Steel

L-SERIES DRAWING

Rendering

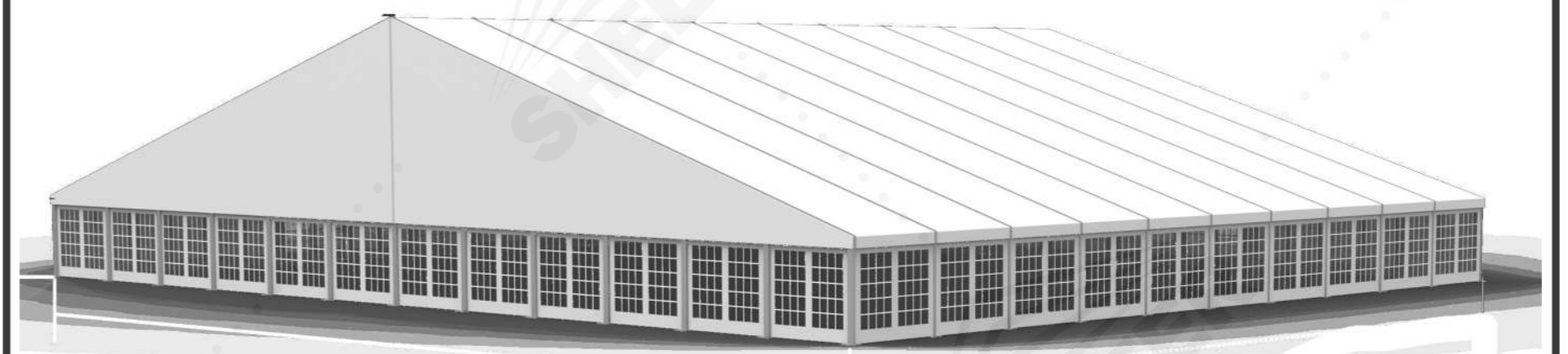

Gable Drawing

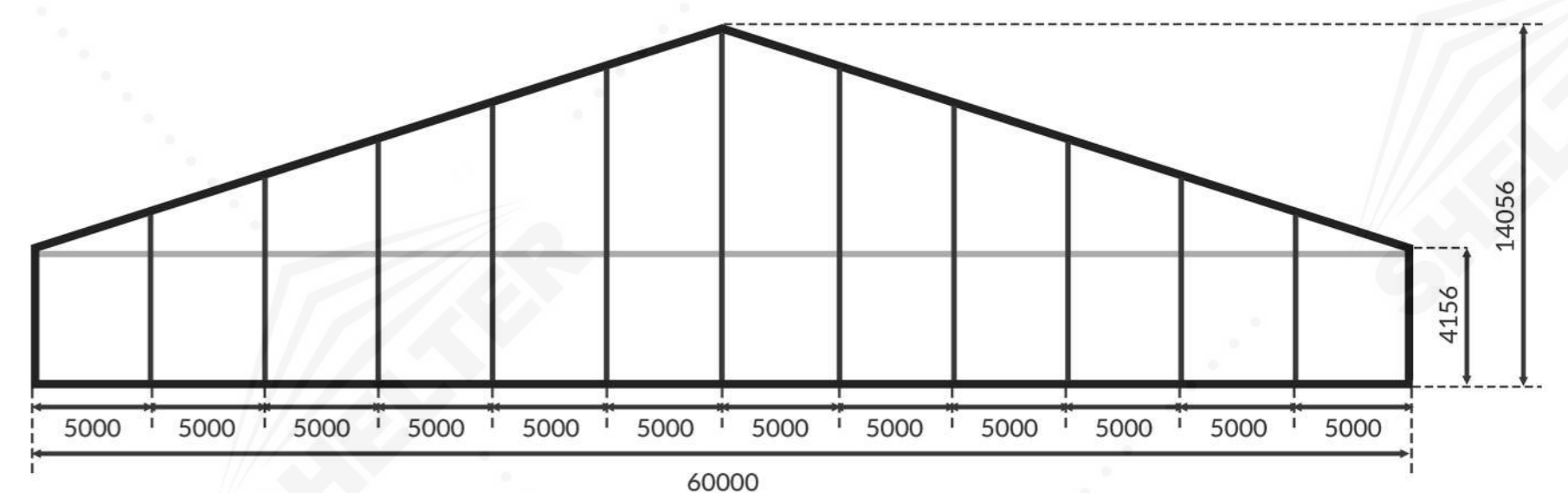

Frame Drawing

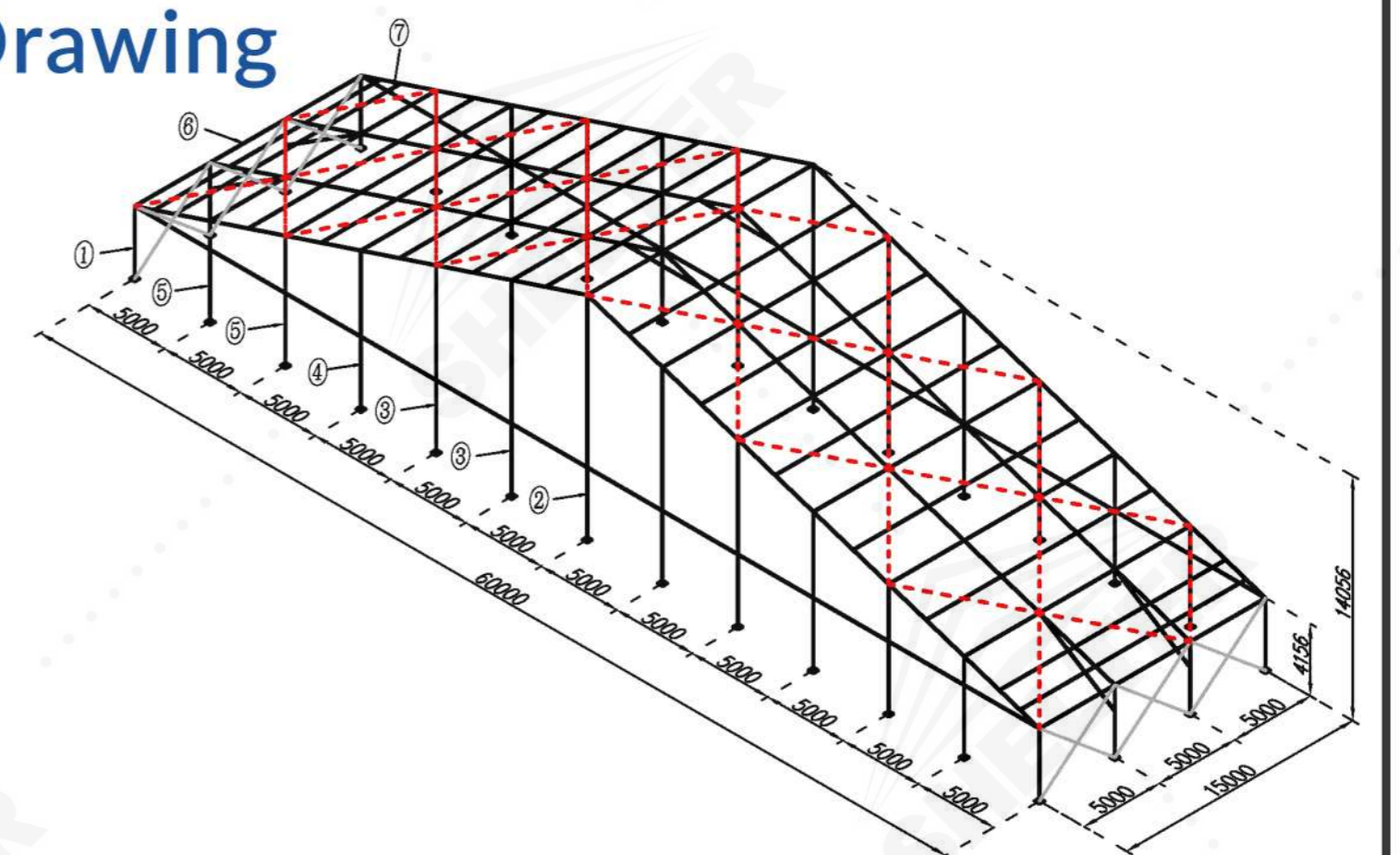

Profile Specifications

Upright Support Roof Beam ①	Gable Middle Upright ②	Gable Upright ③	Gable Upright ④	Gable Upright ⑤
			Eave Purlin ⑥	Roof Purlin ⑦



SHELTER STRUCTURES
TENT MANUFACTURER

Shelter Structures America Inc.

405 Via Chico Suite 1 Palos Verdes Estates, CA 90274

E: robert@shelterstructuresamerica.com

C: (954) 559 8759

W: www.shelterstructuresamerica.com

O: (424) 254 9172